

Ecotourism Australia Presents the 2017 GLOBAL ECO ASIA-PACIFIC TOURISM CONFERENCE



27 - 29 November 2017, Adelaide, South Australia

Delegate Information Kit

Welcome to the 2017 Global Eco Conference!

Ecotourism Australia and the Global Eco Secretariat welcome you to Adelaide, South Australia for the 2017 Global Eco Asia-Pacific Tourism Conference themed '*Ecotourism – Transforming Urban and Regional Tourism*'.

Conference Dates

Day 1:	Monday 27 November	8:20am – 5:00pm
Day 2:	Tuesday 28 November	8:30am – 5:30pm
Day 3:	Wednesday 29 November	8:30am – 5:00pm

Conference Venues

The main plenary sessions (Days 1 & 2) will be held in the **Attenborough Room** at the **Sanctuary Adelaide Zoo (SAZ)**.



Sanctuary Adelaide Zoo - Attenborough Room

Gate 1, Plane Tree Drive

Adelaide, South Australia 5000

SAZ is located on the first floor above the main entrance to Adelaide Zoo. Entry doors are to the right of the Zoo Shop at the front of the building.

Workshop Venues (Day 3)



Sanctuary Adelaide Zoo – Attenborough East Room, Attenborough West Room and Goodall Room

Gate 1, Plane Tree Drive

Adelaide, South Australia 5000

Attenborough East

9:00am – 12:30pm Building and Marketing Ecotourism Experiences

1:30pm – 5:00pm Community Involvement & Strategic Partnerships

Attenborough West

9:00am – 12:30pm Indigenous Ecotourism

1:30pm – 5:00pm Destination Planning & Development

Goodall Room

8:30am – 12:30pm Geotourism

1:30pm – 5:00pm Ecotourism & Wildlife Interactions

Full Details: www.globaleco.com.au

E: info@globaleco.com.au



Adelaide Zoo - Santos Conservation Centre

Gate 1, Plane Tree Drive

Adelaide, SA 5000

9:00am – 12:30pm Tourism in Protected Areas

1:30pm – 5:00pm Ecotourism Operators

Morning tea, lunch and afternoon tea for all delegates on Day 3 will be served at the Sanctuary Adelaide Zoo in the Durrell Gallery.

Getting To Adelaide

Adelaide is easily accessible from all Australian airports and international gateways. The flight to Adelaide from Melbourne is less than 1 hour and just 1 hour, 40 minutes from Sydney. Domestic airlines include: Qantas, Jetstar, Virgin Australia and Tigerair.

International airlines include: Qatar Airways, Emirates, China Southern Airlines, Singapore Airlines, Air New Zealand, Cathay Pacific, Malaysia Airlines, Jetstar International and Fiji Airways (direct flights from 30 June, 2017).

Adelaide Airport is only 15 mins drive or 7 kms from the city centre. Catch a taxi or the Jet Express bus running every 15 mins to make it into town.

Venue & Accommodation Map

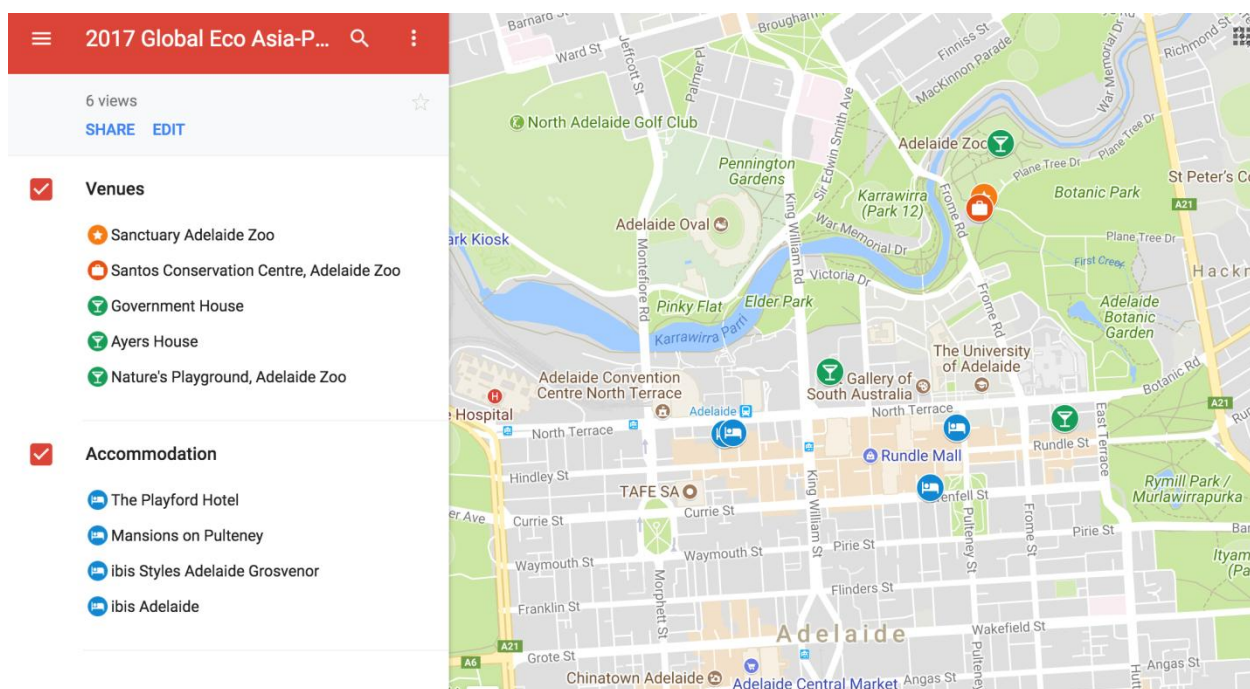

An interactive map listing conference recommended accommodation and conference venues can be accessed at: <https://drive.google.com/open?id=1--FvVH2eCZ3B2ldgACI76Ba9mn9TYkZh&usp=sharing>

Getting To SAZ

Sanctuary Adelaide Zoo is located in Adelaide's city fringe parklands with access to all the services of the central business district, yet with the tranquillity of Botanic Park and the magic of the Adelaide Zoo.



Located on Plane Tree Drive, SAZ is located on the first floor above the main entrance to Adelaide Zoo. Entry doors are to the right of the Zoo Shop on the front of the building.

Address: Gate 1 Plane Tree Drive, Adelaide, SA 5000

Airport: 20 minutes (domestic & International)

Train: 15 min walk from Adelaide train station

Tram: 15 min walk from King William Rd

Parking at SAZ

Metered parking is available (4 hours) or 10 hour parking is available on Plane Tree Drive after Gate 6. Parking is from 8:00am – 6:00pm.

Venue Map

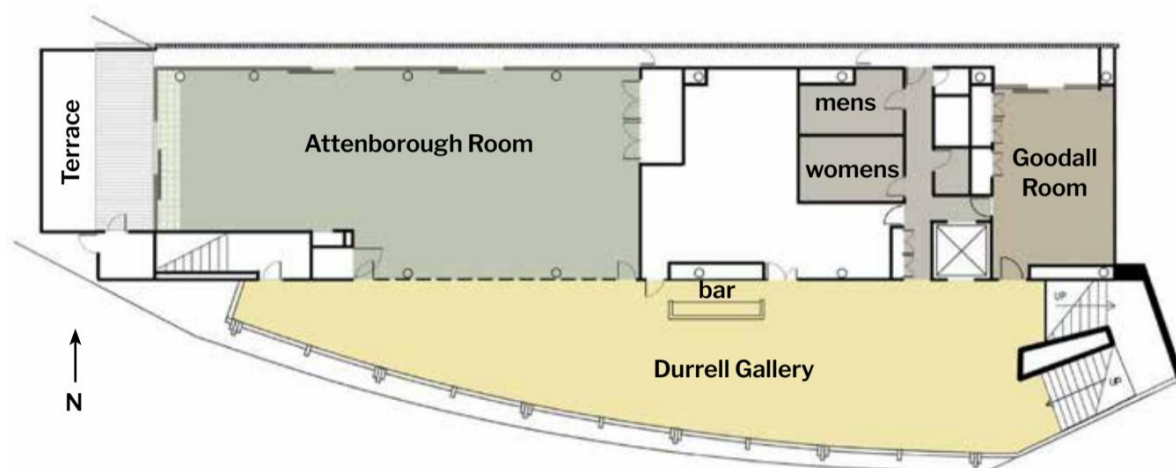

Full Details: www.globaleco.com.au

E: info@globaleco.com.au

Delegate Registration

The registration desk is located in the Durrell Gallery on the first floor of SAZ. This is where you will receive your delegate lanyard name tag and delegate handbook.

Opening Hours

Monday 27 and Tuesday 28 November

Durrell Gallery from 7:30am – 5:00pm

Wednesday 29 November

Durrell Gallery from 7:30am – 4:30pm

Speaker & Chair Briefings

At **8:00am sharp on Monday 27 November** there will be a speakers briefing at the Plenary (Attenborough Room) for the **Monday speakers and chairs**.

At **12:35pm lunchtime on Monday 27 November** there will be a speakers briefing at the Plenary (Attenborough) for the **Tuesday speakers and chairs**.

At **12:35pm lunchtime on Tuesday 28 November** there will be a speakers briefing at the Plenary (Attenborough Room) for the **Wednesday workshop presenters and chairs**.

Conference Program Overview

The full program will be available in the delegate handbook which you will receive upon onsite registration. Program details and details about all speakers can also be viewed on the conference website via the following links:

- ❖ [Conference program](#)
- ❖ [Keynote Speaker Biographies and Abstracts](#)
- ❖ [Concurrent Speaker Biographies and Abstracts](#)

Day 1 – Monday, 27 November – Plenary Program

Attenborough Room, SAZ

8:20am - 8:40am	Welcome to Country
8:40am - 8:45am	Convenor Welcome Tony Charters AM, Convenor, Global Eco Asia-Pacific Tourism Conference
8:45am - 8:50am	Ecotourism Australia Welcome Rick Murray, Chairman, Ecotourism Australia
8:50am - 9:00am	Official Welcome The Hon Ian Keith Hunter MLC, Minister for Sustainability, Environment and Conservation, Minister for Water and the River Murray, Minister for Climate Change

Ecotourism and Private Conservation

Session Chair	Tony Charters AM, Convenor, Global Eco Conference
9:00am - 9:25am	Keynote Speaker Atticus Fleming, Chief Executive, Australian Wildlife Conservancy
9:25am - 9:50am	Keynote Speaker TBC
9:50am - 10:15am	Keynote Speaker Brendon Bevan, Manager, Arkaba Conservancy and The Arkaba Walk
10:15am - 10:30am	Q & A
10:30am - 11:00am	Morning Tea

Tourism and The Chinese Dream

Session Chair **Tony Charters AM, Convenor, Global Eco Conference**

11:00am - 11:25am **Keynote Speaker**
Prof. David Simmons, Professor of Tourism, Faculty of Environment, Society and Design, Lincoln University

Tourism in Protected Areas

Session Chair **Tony Charters AM, Convenor, Global Eco Conference**

11:25am - 11:50am **Keynote Speaker**
Dr. Russell Reichelt, Chairman and CEO, Great Barrier Reef Marine Park Authority

11:50am - 12:15pm **Keynote Speaker**
Cameron Miller, CEO, Ngurratjuta/Pmara Ntjarra Aboriginal Corporation

12:15pm - 12:30pm **Q & A**

12:30pm - 1:30pm **Lunch**

Tourism and Protected Area Management Forum

Session Chair **Tony Charters AM, Convenor, Global Eco Conference**

1:30pm - 1:55pm **Keynote Speaker**
Sandy Pitcher, Chief Executive DEWNR, South Australia

1:55pm - 2:20pm **Keynote Speaker**
Haydyn Bromley, Presiding Member, Aboriginal Lands Trust

Forum - Protected Area Managers and Tourism Commissions

Session Chair **Sandy Pitcher, Chief Executive DEWNR, South Australia**

Keynote Panelists:

- 2:20pm - 3:00pm - Jacinta Overman, Coordinator, Tourism and Concessions, Department of Biodiversity, Conservation and Attractions
 - Chris Day, Director, Central Australian Parks, Parks and Wildlife

3:00pm - 3:30pm **Afternoon Tea**

Wildlife and Ecotourism

Session Chair **Dr. Claire Ellis, Deputy Chair, Ecotourism Australia**

3:30pm - 3:55pm **Keynote Speaker**
Dr. Jenny Gray, CEO of Zoos Victoria and President of the World Association of Zoos and Aquariums

3:55pm - 4:20pm **Keynote Speaker**
Elaine Bensted, Chief Executive, Zoos South Australia

Panel Discussion - Wildlife Interactions**Keynote Panelists:**

4:20pm - 5:00pm Elaine Bensted, Chief Executive, Zoos South Australia
 Jillian Blackbeard, Marketing Manager, Botswana Tourism Organisation
 Dr. Jenny Gray, President of the World Association of Zoos and Aquariums
 Cameron Kerr, CEO, Taronga Conservation Society
 Andrew Wright, General Manager & Master, Calypso Star Charters

Day 2 – Tuesday, 28 November – Plenary Program

Attenborough Room, SAZ

Community Ecotourism and Social License

Session Chair Tony Charters AM, Convenor, Global Eco Conference

8:30am - 8:50am **Keynote Speakers**
Alfred Wellington, Chief Executive Officer, Jerrinja Local Aboriginal Land Council

Full Details: www.globaleco.com.au

E: info@globaleco.com.au

Delia Lowe, Deputy Chair, Jerrinja Local Aboriginal Land Council

8:50am - 9:10am **Keynote Speaker**
Joselito Costas, Tourism Officer, Department of Tourism, Cebu, Philippines

9:10am - 9:30am **Keynote Speaker**
Shu Tan, Founder & Director , Sapa O'Chau

9:30am - 9:50am **Keynote Speaker**
Rashmini Mather, Tourism Strategic Planner, Sri Lanka

9:50am - 10:05am **Q & A**

Ecotourism Australia Report

10:05am - 10:30am **Keynote Speaker**
Rod Hillman, CEO, Ecotourism Australia

10:30am - 11:00am **Morning Tea**

Ecotourism and Philanthropy

Session Chair **Andrew Fairley AM, Chairman, The Sir Andrew and Lady Fairley Foundation**

11:00am - 11:20am **Keynote Speaker**
Andrew Fairley AM, Chairman, The Sir Andrew and Lady Fairley Foundation

Panel Discussion **Keynote Panelists:**

11:20am - 11:50am Hiran Cooray, Owner, Jetwing
Atticus Fleming, Chief Executive, Australian Wildlife Conservancy
Anthea Hammon, Managing Director, Scenic World
Keith Sproule, Executive Director, Abercrombie & Kent Philanthropy

Geotourism and the Chinese Market

Full Details: www.globaleco.com.au

E: info@globaleco.com.au

Session Chair	Rod Hillman, Chief Executive, Ecotourism Australia
11:50am - 12:10pm	Keynote Speaker Dr. Young Ng, Member, Geotourism Standing Committee of the Geological Society of Australia
12:10pm - 12:30pm	Keynote Speaker Derek Tse, HK Traveller, Hong Kong

12:30pm - 1:30pm **Lunch**

Asia-Pacific Forum

Session Chair	Tony Charters AM, Convenor, Global Eco Conference
1:30pm - 1:55pm	Bharat Basnet, Chairman, The Explore Nepal Group
1:55pm - 2:20pm	Keynote Speaker Hiran Cooray, Owner, Jetwing
2:20pm - 2:45pm	Keynote Speaker Dr. Chuwit Mitrchob, Deputy Director-General, Designated Areas for Sustainable Tourism Administration
2:45pm - 3:00pm	Q & A
3:00pm - 3:30pm	Afternoon Tea

Innovation and Ecotourism Futures

Session Chair	Tony Charters AM, Convenor, Global Eco Conference
3:30pm - 3:55pm	Keynote Speaker Jillian Blackbeard, Marketing Manager, Botswana Tourism Organisation

3:55pm - 4:20pm	Keynote Speaker Joep Koster, Managing Partner, Soel Yachts
4:20pm - 4:45pm	Keynote Speaker Keith Sproule, Executive Director, Abercrombie & Kent Philanthropy
4:45pm - 5:00pm	Q & A
5:00pm	Announcement of the 2018 Conference Host & Conference Close Rick Murray, Chairman, Ecotourism Australia

Day 3 – Wednesday, 29 November

Morning Options (Choose to attend one of four)

8:30am – 12:30pm

1. Geotourism

9:00am – 12:30pm

2. Building and Marketing Ecotourism Experiences
3. Indigenous Ecotourism
4. Tourism in Protected Areas

12:30pm – 1:30pm Lunch

Durrell Gallery, SAZ

Afternoon Stream Options (Choose to attend one of four)

1:30pm – 5:00pm

1. Community Involvement & Strategic Partnerships
2. Destination Planning and Development
3. Ecotourism Operators
4. Ecotourism and Wildlife Interactions

Optional Networking Functions

WELCOME COCKTAIL RECEPTION

Date: Monday, 27 November 2017
Venue: Government House
Address: King William Rd, Adelaide, SA 5000
Time: 5:30pm - 6:30pm
Dress: Business informal
Cost: Free of charge. **Registrations closed on 20 Nov 2017.**

CONFERENCE DINNER

Date: Tuesday, 28 November 2017
Venue: The Conservatory, Ayers House
Address: 288 North Tce, Adelaide, SA 5000
Time: 7:00pm - 10:30pm
Theme: Zoo Animals
Dress: Semi-formal
Cost: \$155 per person.

CLOSING NETWORKING FUNCTION

Date: Wednesday, 29 November 2017
Venue: Nature's Playground, Adelaide Zoo
Address: Gate 1, Plane Tree Dr, Adelaide, SA 5000
Time: 5:00pm - 7:30pm
Dress: Business informal
Cost: \$85 per person.

Accommodation

Visit <https://2017.globaleco.com.au/delegate-information/accommodation> to view conference recommended hotels in the Adelaide CBD who are offering Global Eco delegates special accommodation rates.

Pre and Post Conference Tours

Visit <https://2017.globaleco.com.au/technical-tours> for further details and how to book.

Dress Codes

The dress code for the conference program is smart casual.

The dress code for the networking functions is corporate and semi-formal.

Adelaide Climate

Spring (September – November) sees weather warm up with average temperatures between 11 – 22°C (53 – 71°F). Rainfall is low but evenings can be quite brisk as temperatures drop quickly.

Full Details: www.globaleco.com.au

E: info@globaleco.com.au

Internet Access

Wireless Internet is available at SAZ for web browsing and checking emails. It is not suitable for downloading or streaming large files. To access the Wi-Fi, please see the conference registration desk.

Onsite Contact Numbers

Keynote Speakers:	0418 122 025 (Tony Charters AM, Conference Convenor)
Concurrent Speakers:	0474 747 773 (Racheli Evanson, Events Coordinator)
Registration:	0474 747 773 (Racheli Evanson, Events Coordinator)
Media:	0418 122 025 (Tony Charters AM, Conference Convenor)
AV:	0474 747 773 (Racheli Evanson, Events Coordinator)
Sponsors:	0418 122 025 (Tony Charters AM, Conference Convenor)

Stay Connected

Please connect with us on Facebook and Twitter for last minute changes in the program and important announcements.



<https://twitter.com/globalecoconf>

#globaleco17



<https://www.facebook.com/globalecoconference?fref=ts>

2017 Conference Host



2017 Supporters



LORD HOWE ISLAND
just paradise.

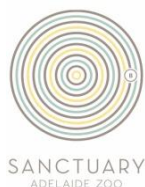

SEALINK
Kangaroo Island



Convenor



Affiliate Member of



Full Details: www.globaleco.com.au

E: info@globaleco.com.au